

CHAIN SAW PETROL

Quick Guide

Read the operating instructions and do not use the machine before you understand the instructions.

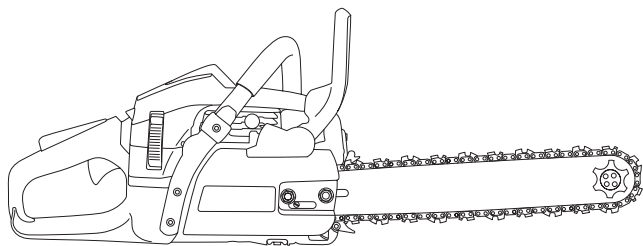

SAFETY INSTRUCTIONS



1. OPERATING FUNCTIONS

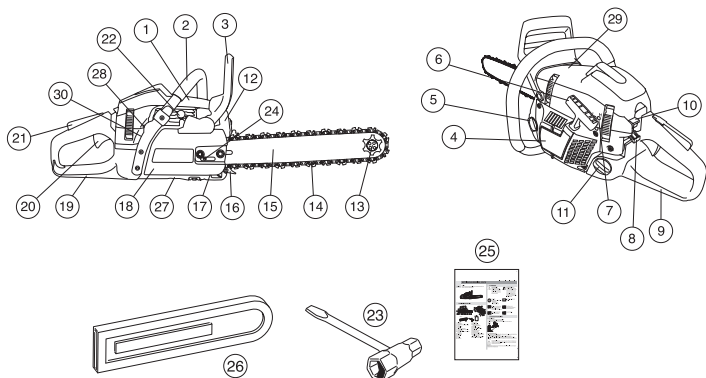

- | | |
|---|---|
| 1 Cylinder cap | 16 Leverage bumper |
| 2 Front handle | 17 Chain catcher |
| 3 Chain brake with back lash protection | 18 Clutch cover |
| 4 Starter protection | 19 Rear hand grip with right hand protection |
| 5 Chain oil tank | 20 Throttle lever |
| 6 Starter lever | 21 Throttle lock |
| 7 Carburetor tuning screws | 22 Decompression valve (Model 359) |
| 8 Choke lever / starter throttle lock | 23 Combination wrench |
| 9 Rear handle | 24 Chainsaw tensioning screw |
| 10 Stop switch (On and off ignition.) | 25 Operating Instructions |
| 11 Fuel tank | 26 Transport protection |
| 12 Exhaust mufflerscrew | 27 Oil pump adjustment |
| 13 Nose Wheel | 28 Switch for handle heating (Model 357XPG, 359G) |
| 14 Chain | 29 Information and warning label |
| 15 Saw blade | 30 Product and serial number type plate |

2. FUEL MANAGEMENT

Fuel safety

- Never refuel while the engine is running.
- Ensure good ventilation during refuelling.
- Move the machine at least 3 m from where you refuelled before starting the engine.

Fuel

Take note! Your machine is equipped with a two-stroke engine; Always use Aspen 2T fuel from the rental center!



CAUTION! Always ensure proper ventilation when filling and handling fuel.

Chain oil

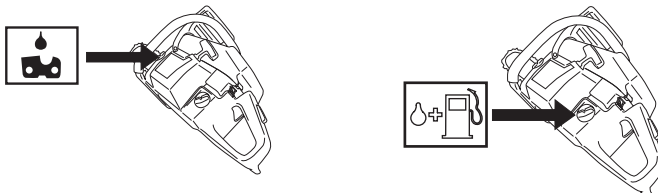

- As a lubricant we recommend a special oil (chain oil) with good adhesion.
- Contact Boels Rental for the correct chain oil.



CAUTION! To reduce the risk of fire, take the following precautions:

- Stop the engine and allow it to cool for a few minutes before refuelling.
- Carefully open the fuel cap when you want to refuel so that any excess pressure is slowly released.
- Thoroughly tighten the fuel cap after refuelling.



CAUTION! Fuel and fuel vapours are flammable.

Be careful when handling fuel and chain oil. Consider the fire, explosion and inhalation risks.

3. STARTING AND STOPPING



CAUTION! Before starting, take into account the following points: The chain brake must be activated when the saw is started to reduce the risk of contact with the rotary chain at start.

Otherwise, the clutch may loosen and cause personal injury. Always place the machine on a solid surface. Make sure you are standing sturdy and that the chain cannot come into contact with an object. Keep unauthorised people out of the work area.

Cold motor:

Start: the chain brake must be activated when starting the engine. Activate the brake by pushing the reversal guard forward.

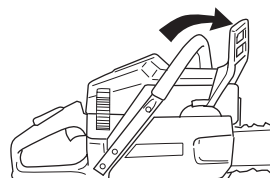

Ignition;choke: engage the choke lever. The stop switch will be automatically set to the starting position.

Starting throttle: the combined choke / start throttle position is achieved by moving the lever to the choke position.

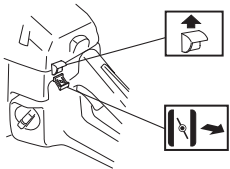

If the machine is equipped with a decompression valve (A): press the valve to reduce the pressure in the cylinder and facilitate the start of the machine. The decompression valve must always be used when starting. When the machine has started, the valve automatically returns to its initial position.

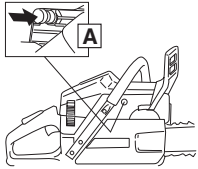

Starting

Grasp the front handle with your left hand. Place your right foot on the rear handle and push the saw to the ground. Hold the start lever, pull the starter cord slowly with your right hand until you feel resistance (the engage mode hooks in) and then make rapid and powerful pulls. Never wrap the starter cord around your hand.



Press the choke lever the moment the motor ignites, and repeat the start attempts until the motor starts. When the engine starts: Give it full throttle; This will allow the throttle lever to automatically move back to the starting position. Because the chain brake is still activated, the engine revs must be returned to idle speed as quickly as possible, do this by turning the gas lock off quickly.

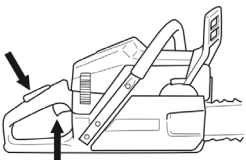

Note! Reset the chain brake by returning the back lash protection to the handle bracket. The motor chain saw is then ready for use.

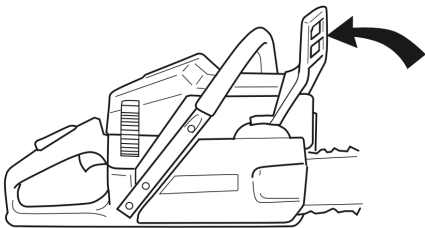

- Always hold the chain saw with both hands. Hold your right hand on the rear handle and your left hand on the front handle. All users, both right and left handed, should use this handle. Place your thumbs and fingers firmly around the motors chain saw handles.



Stopping

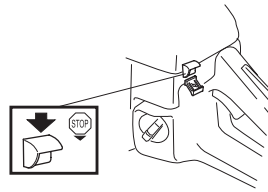

You stop the motor by pushing the stop switch to the stop position.

GENERAL INSTRUCTIONS

Chain tension

The more you use the chain, the longer it becomes. It is therefore important to tension the chain regularly. Check the chain tension each time you refuel.

NOTE! A new chain must be "run in". Therefore, you need to check the tension of a new chain more often.

- In general, you should tighten the chain as tight as possible, but not so tight that it cannot be turned by hand.

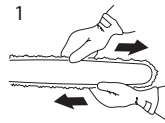

- Unscrew the saw blade nuts that hold the clutch cover and the chain brake in place. Use the combination wrench. Turn the saw blade nuts by hand as firmly as possible.

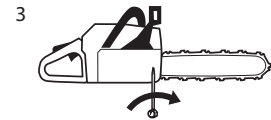
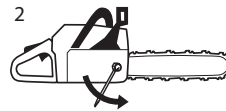

- Lift up the saw blade and tighten the chain by tightening the chain tensioner screw using the combination wrench. Tighten the chain so that it no longer hangs loose on the underside of the saw blade.

- Use the combination wrench and tighten the saw blade nuts while keeping the saw blade point up. Make sure that the chain can be easily rotated by hand and that it is not loose on the underside of the saw blade.



The position of the chain tension screw on our motor chainsaws differs per model.

Prevent recoil



WARNING! Recoil can occur suddenly and strongly; Thereby flinging the motor chain saw, saw blade and chain in the direction of the user. When this happens while the chain is in motion, this can cause serious or even fatal injury. It is essential that you understand what causes a recoil and how to prevent them by applying the correct working technique.



The product must be returned clean and undamaged. Contact the rental company in case you experience a problem with the device!