

LAWN SCARIFIER PETROL

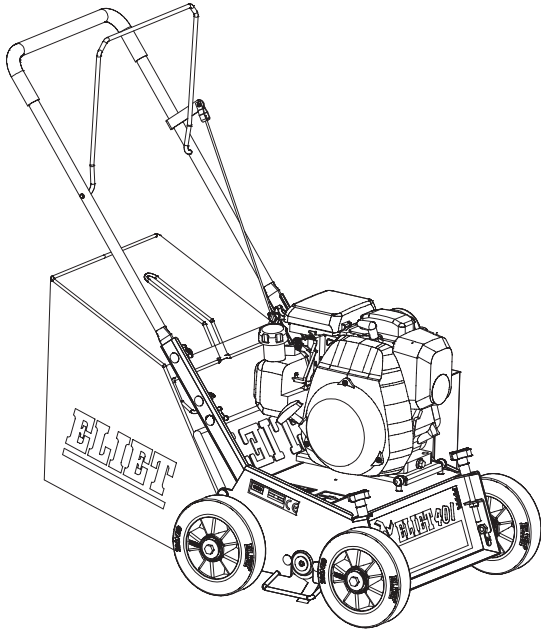

SAFETY INSTRUCTIONS



- Legal regulations and requirements apply at all times.
- Always wear the prescribed safety clothing: gloves, safety glasses, ear protectors, safety shoes.
- Use this device only for its intended purpose and as described in this manual.
- The maximum working depth is 2 mm into the soil.
- Only start the motor at the workplace.
- Always check the surrounding area for foreign objects: stones, tree roots, water well covers, foundations, irrigation systems, power outlets and possibly the presence of cabling or pipelines in the soil.
- Only engage the blades when the machine is on the lawn.
- During work, keep bystanders at a safe distance from the machine (5m).
- Never lift the rubber guard of the blades.
- Never remove the collecting bag without turning off the blades.
- Never reach with your hands in the ejector outlet.
- In case of a strange noise or uncertainty, disengage the blades, turn off the motor and check the machine
- Never tie the blade release lever to the steering wheel with a rope, tape or any other material.
- Machine parts can get hot, do not touch them.
- Always switch off the motor before leaving the workplace.
- Only run the machine outdoors to avoid exhaust poisoning.
- Smoking while operating, refueling and servicing the machine is prohibited.
- Always turn off the motor and let it cool down before refueling.
- Always park the device on a horizontal surface; not on a slope.
- Always switch off the engine and disconnect the spark plug cable before performing any maintenance.
- Never tilt the machine sideways to transport it.

1. PARTS AND OPERATING FUNCTIONS

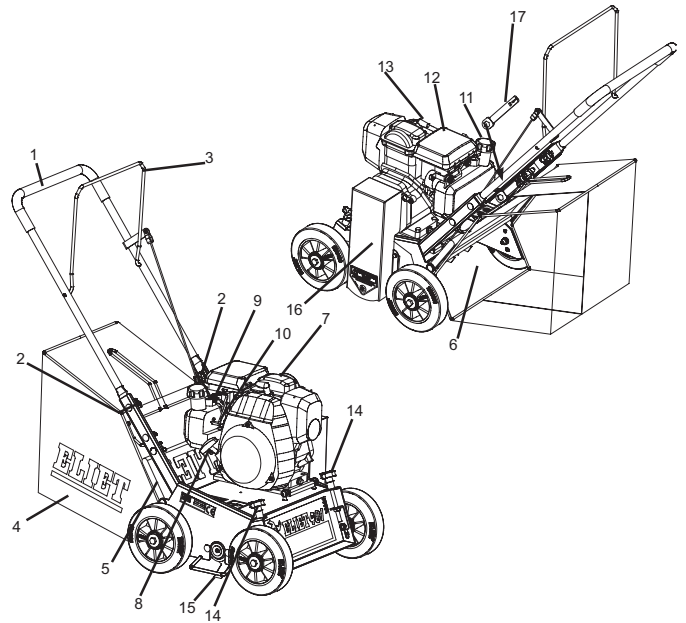

- | | |
|---------------------------------------|-----------------------------------|
| 1. Push bracket | 10. Throttle lever / Start-Stop |
| 2. Screws for tightening push bracket | 11. Fuel cap |
| 3. Blade operating lever | 12. Air filter |
| 4. Collecting bin | 13. Spark plug |
| 5. Protective cover | 14. Depth adjustment front wheels |
| 6. Ejector opening | 15. Blades |
| 7. Motor | 16. Belt transmission |
| 8. Starter pull cord | 17. Tools |
| 9. Choke lever | |

2. BEFORE STARTING

1. Clear the area of people and foreign objects.
2. Mow the lawn before using the scarifier (grass length <3 cm).
3. Check the depth setting of the blades (max. 2 mm deep).
4. Place the scarifier on the lawn.
5. Attach the collecting bin.
6. Check that there is enough fuel in the tank.

NOTE! Always use Aspen 4T fuel from the rental center!

3. STARTING THE MOTOR

1. Put the throttle lever to full power.

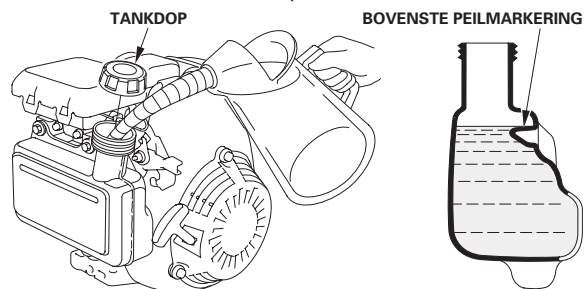

2. Pull the choke lever back.

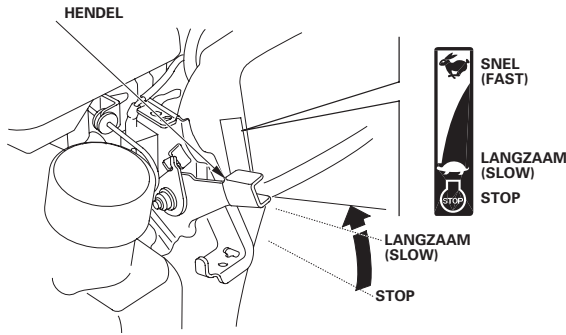

3. Pull the starter cord until the motor starts.
 4. Press the choke lever back in.
 5. Always work with full throttle.
- To switch off the motor, push the throttle lever completely down.

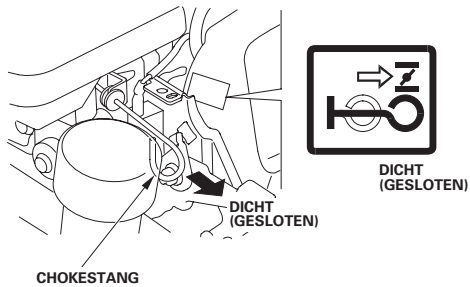

4. DETHATCHING

1. Press the push bracket down so that the front wheels lift up 3 to 4 cm.
2. Pull the clutch lever backwards so that the blades engage.
3. Lower the lawn scarifier until the front wheels rest on the ground.
4. Manoeuvre the lawn scarifier across the lawn.
5. Adjust the driving speed to the amount of moss in your lawn.
6. At the end of a strip release the clutch lever to disengage the blades and make a turn.
7. Follow steps 1 to 3 to start a new strip.
8. Regularly check if the collecting bin is full. Empty if required.
9. In order to get an intense dethatching effect, it is advisable to rake the terrain at right angles.

5. EMPTYING THE COLLECTING BIN

1. If the machine loses moss, this indicates that the collecting bin is full or the ejector is blocked.
2. Disengage the blades by releasing the blade operating lever.
3. Wait until the blades have come to a standstill.
4. Move the rubber flap upwards and lift the collecting bin from its seating.
5. Push the vertical machine without the collecting bin slightly forward, releasing trapped moss beneath the machine.
6. Never reach with your hands in the ejector outlet.
7. Never tilt the machine forward as this may unintentionally engage the blades.
8. After emptying the collecting bin, lift the rubber flap and replace the collection bin in its seating.

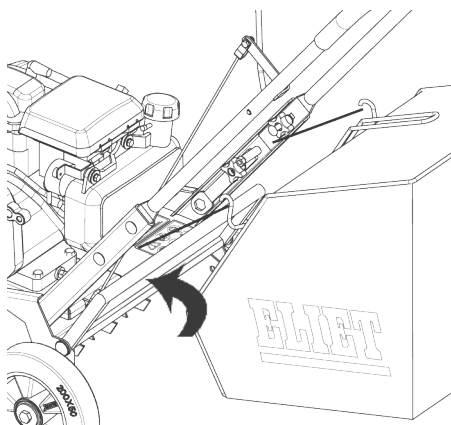

6. ADJUST THE DEPTH SETTING

1. Switch off the engine.
2. Place the machine on a flat hard surface (e.g. concrete).
3. Remove the tool that comes with the machine.
4. Using the wrench loosen the bolts of the front wheels half a turn (fig. 1)
5. Place the tool under one of the front wheels. (figure 2)
6. Turn the blades so that they point downwards.
7. Now turn the depth adjustment knob on the wheel in question until the blades touch the ground (figure 3)
8. Then repeat with the other wheel.
9. Then tighten the bolts of both wheels firmly.
10. Replace the tool in its holder.

7. TRANSPORTING THE MACHINE

1. Always switch off the motor before transporting the machine.
2. Fold the push bracket forward for a compact transport.
3. Remove the collecting bin.
4. To do this, loosen the two wing screws sufficiently.
5. Then push both steering brackets towards each other so that the handle comes loose from the u-shaped profiles.
6. At the same time tilt the push bracket forward until it rests on the belt cover.
7. Tighten the screws slightly so that they do not fall off during transport.

NOTE:

This lawn scarifier weighs 40 kg, avoid back injuries, lift using your legs. If the weight is too much ask for assistance.

8. TROUBLESHOOTING

THE MOTOR DOES NOT START:

- Throttle lever is still in the lower position
- You forgot to use choke
- Fuel tank is empty
- Spark plug cap is not attached to spark plug
- Too little oil in the motor

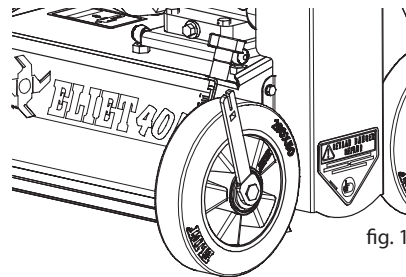

fig. 1

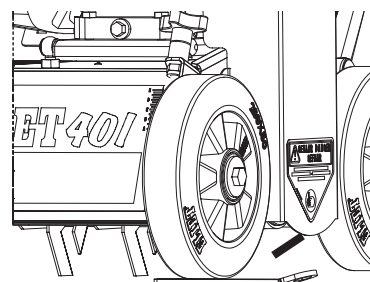

fig. 2

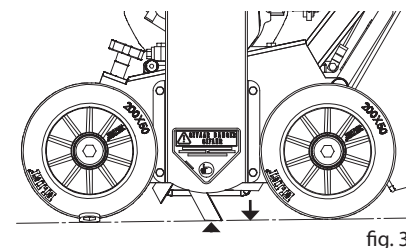

fig. 3

9. MAINTENANCE AND CLEANING

Contact your rental company should you encounter problems with the machine!

The product must be returned clean and undamaged.