

WET/DRY VACUUM CLEANER

Use according to design

The machine is intended for collecting, vacuuming, conveying and separating non-combustible dry matter, wood dust, non-flammable liquids and a mixture of air and water. The vacuum cleaner is dust technically-tested and classified for dust class M. Use the vacuum cleaner only when you can fully understand all functions and use without restrictions or received instructions.



SAFETY INSTRUCTIONS



- Read all safety warnings and all instructions. Failure to follow the warnings and regulations may result in an electric shock, fire or serious injury.
- Caution! Never vacuum asbestos-containing substances. Asbestos is a carcinogen.
- Caution! Use the vacuum cleaner only if you can fully understand all functions and use without restrictions or you have received instructions. You reduce the chance of improper operation and injury.
- Caution! The vacuum cleaner is suitable for vacuuming dry matter.
- Caution! Do not vacuum combustible or explosive liquids such as gasoline, oil, alcohol and solvents. Do not vacuum hot or burning dust. Do not use the vacuum cleaner in an explosion hazardous space. Dust, vapours or liquids can ignite or explode.
- Unplug from the mains before making adjustments to the vacuum cleaner, changing accessories or storing it. This precaution prevents unintentional starting the vacuum cleaner.
- Ensure good ventilation of the work area.
- Do not allow children to use the vacuum cleaner without supervision. Children may get injured.
- The vacuum cleaner contains dust that is hazardous to health. Only allow a specialist to empty the device and perform maintenance on the device. This also applies for removing the dust collection reservoir. Suitable protective equipment is necessary. Do not use the vacuum cleaner without the complete filter system. Otherwise you endanger your health.
- Check the condition of the vacuum hose before operating. Allow the vacuum hose to be mounted on the device so that no dust comes out unintentionally. Otherwise you can inhale dust.
- Handle the power cord and the vacuum hose with care. Otherwise, you may endanger other people.
- Do not clean the vacuum cleaner with a direct water jet. The penetration of water into the upper part of the vacuum cleaner increases the risk of electric shock.

1. ILLUSTRATED COMPONENTS

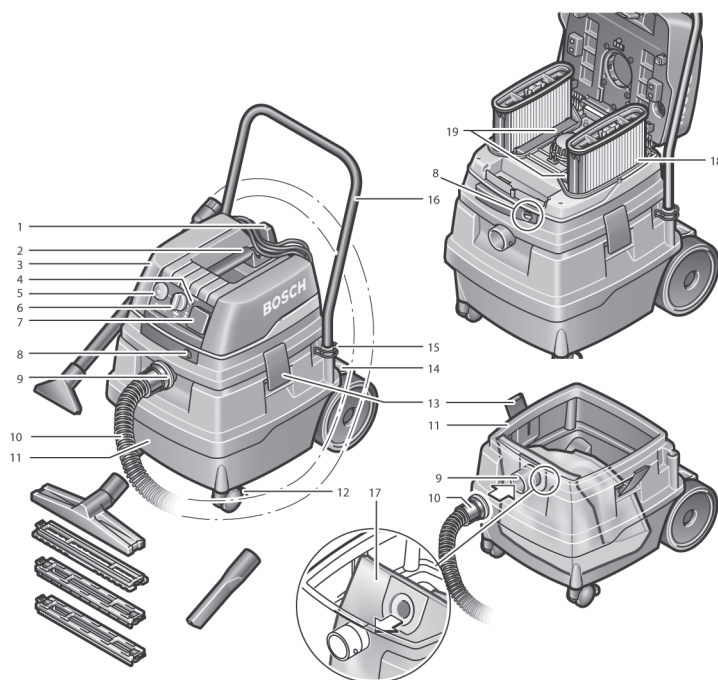

- | | |
|-------------------------------|----------------------------|
| 1 Cable holder | 10 Vacuum hose |
| 2 Carrying handle | 11 Container |
| 3 Vacuum lid | 12 Castor brake |
| 4 Warning lamp | 13 Latch for lid |
| 5 Airflow regulator | 14 Accessory storage |
| 6 Function switch | 15 Clamp for guide bracket |
| 7 Socket for Electrical tools | 16 Guiding bracket |
| 8 Lock | 17 Dust bag |
| 9 Hose connector | 18 Harmonic folded filter |
| | 19 Motor protection filter |

2. ASSEMBLY



CAUTION! Always remove the plug from the mains before working on the vacuum cleaner.

Swap or place dust bag

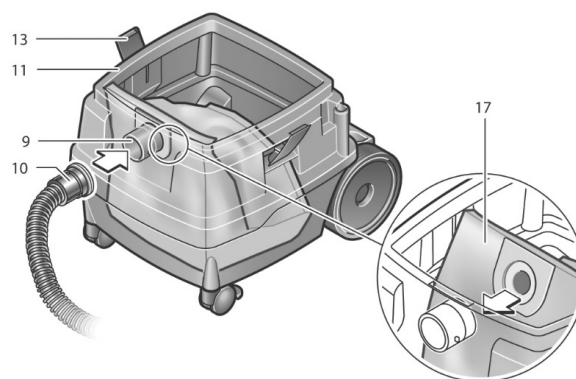

- Open the latches **13** and remove the lid **3** of the vacuum cleaner.
- Remove the full dust bag **17** from the connecting flange at the rear. Close the dust bag opening by lowering the lid. Take the sealed dust bag out of the vacuum cleaner.
- Place the new dust bag **17** over the connection flange. Check that the dust bag **17** is flush across the full length against the inside of the container **11**. Place lid top **3** on the vacuum cleaner.
- Close the latches **13**.

For dry vacuuming, use a dust bag **17**. When using a dust bag **17** folding filter **18** clogs up at a slower rate free, the vacuuming performance remains longer and disposal of the dust is easier.

Vacuuming directly into the container is possible when no hazardous

substances or substances without an exposure value $\geq 1 \text{ mg} / \text{m}^3$ according to class L (so far use category U) are vacuumed.

If during the IS function, the warning light **4** flashes and / or during the ENT function the alarm sounds, the folding filters **18** must be cleaned. Set the function switch **6** on the symbol **electromagnetic filter cleaning**. The harmonic folding filters will be cleaned for approx. **10** seconds .

Should the warning light **4** continue to blink and / or the alarm signal sound than the dust bag **17** must be replaced.

If the warning light **4** still flashes and / or the alarm signal sound, the vacuum cleaner must be checked as described in the "Faults" section.

on

Turning on

off

Turning off

Electro magnetic cleaning of the filter

Use with automatic remote control (ENT function)

	A [U]	B [P]	C [P(max.)]
EU	230 V	1 200 W	2 500 W
CH	230 V	1 200 W	1 100 W

The vacuum cleaner has an integrated earthed outlet **7**. To which an external power tool can be connected. The vacuum cleaner automatically switches on via the connected power tool. Observe the maximum permitted power rating of the connected power tool.

Set the air flow controller **5** according to the 35 mm hose used.

The minimum flow rate (airflow) of the connected power tool must be achieved to ensure adequate dust extraction at the vacuuming site.

Hose diameter	Setting airflow
35 mm	70 m³/h

Set the function switch **6** on the symbol for **automatic remote control**. In this function, the volume flow will be according to the setting set to the air flow controller **5** and electronically monitored. In a correctly chosen setting, sufficient dust extraction is ensured. To switch on the vacuum cleaner, turn on the power tool connected to socket **7**. The vacuum cleaner starts automatically. If the warning light **4** blinks and the audio signal sounds, the vacuum cleaner must be checked as described in the "Faults" section. Turn off the power tool if you want to switch off the vacuum cleaner.

The vacuum cleaner will switch off automatically after approx. 6 seconds.

In the function ENT, with automatic remote control, the electronic start current is limited when the power of the vacuum cleaner is switched on thus allowing the use of a 16 A fuse.

Electromagnetic cleaning of the filter

The vacuum cleaner is equipped with electromagnetic cleaning of the filter, which removes dust from the folded harmonic filter **18**. Eventually when the vacuuming capacity is insufficient, the filter cleaning system must be operated.

Set the function selector switch **6** to the symbol **electromagnetic filter cleaning**.

Any power tools that are connected must be switched off.

The vacuum vibrates for approx. 10 seconds and turns off automatically.

Wait shortly before you start vacuuming again so that dust can settle into the container.

How often you clean the filter depends on the type and the amount of dust.

With regular use, the maximum vacuuming capacity remains longer.

3. MAINTENANCE AND CLEANING

- **Always remove the plug from the mains before working on the vacuum cleaner.**
- **For safe and proper work keep the vacuum cleaner and ventilation openings clean.**

Class M vacuum cleaners that operate in a contaminated environment, the outside and all parts of the machine must be cleaned or treated with sealing agents.

When performing maintenance and repairs, all contaminated parts that can not be cleaned properly should be disposed of.

For maintenance by the user, the vacuum cleaner must be disassembled, cleaned and inspected, provided that it is not hazardous for maintenance staff and other persons.

Before disassembling, clean the vacuum cleaner to prevent any hazards.

The area in which the vacuum cleaner is disassembled should be well ventilated.

During maintenance, wear personal protective equipment.

Level sensors

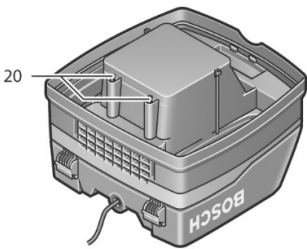

Clean the level sensors **20** regularly.

Open the latches **13** and remove the lid **3** of the vacuum cleaner.

Clean the level sensors **20** with a soft cloth.

Place the lid **3** again on the vacuum cleaner and close latches **13**.

Malffunctions

- If the warning light **4** blinks and / or the audio signal sounds, the harmonic folding filters **18** must be cleaned. Set the function selector switch **6** to the symbol **electromagnetic filter cleaning**. The harmonic folding filters will be cleaned for approx. 10 seconds cleaned.
- Check that the air flow controller **5** is in the correct position for the hose diameter used.
- Tap the remaining dust of the harmonic folding filters **18** and replace the harmonic folding filters if necessary **18**.
 - Check if the opening of the dust bag **17** is not blocked and whether the dust bag **17** is full. Replace the dust bag **17** in that case. Should, after restarting, the warning light **4** flash again and / or the audio signal sounds, proceed as follows:
 - In the function **ENT with automatic remote control** turn off the connected power tool and disconnect the power plug from the socket **7**.
 - Switch on vacuum cleaner.
 - Connect a 35 mm hose.
 - If the warning light **4** does not flash, piston and vacuum hose are in order.
 - If the warning light **4** blinks, check the vacuum system and the vacuum hose **10** for any remaining dirt.
 - If the warning light **4** still flashes, you need to clean or replace the harmonic folding filters **18**.
 - If the vacuum capacity is not still not sufficient, the vacuum cleaner must be brought to customer service.

The product must be returned clean and undamaged.

Contact the rental company should you encounter problems with the machine.